



South Kingstown School District

School Building Committee Update
November 3, 2022

Agenda

RIDE Stage II (the “Project”) Definition

Approvals Needed

Schedule Duration

Workshop Approach

Next Steps

RIDE Stage II

The “Project”

Scope – What is SK asking RIDE to consider for reimbursement?

New Building ?

Renovations and Additions ?

New Fields ?

Asset Protection (Warm, Safe, Dry) ?

Cost – What is the 3rd party independent cost estimate for the Scope?

Approvals Needed - Upon definition of the “Project”

School Building Committee

Recommendation to submit RIDE Stage II (the “Project”) to the School Committee & Town Council

School Committee

Approves the RIDE Stage II (the “Project”) Submission to RIDE SBA

Town Council

Approves the RIDE Stage II (the “Project”) Submission to RIDE SBA

Approvals Needed - Upon definition of the “Project”

RIDE School Building Authority

Recommendation to approve RIDE Stage II (the “Project”) to the Council on Elementary & Secondary Education

RIDE Council on Elementary & Secondary Education*

Approves the RIDE Stage II (the “Project”) for reimbursement

Memorandum of Agreement Issued by RIDE

Scope and Cost eligible for reimbursement

Approvals Needed - Upon definition of the “Project”

Town Council*

Approval to move forward with a Bond Vote

State Legislature*

Grants enabling legislation for a Bond Vote

*Do NOT need to be in any specific order.

For example:

North Providence has a \$125 M Bond Vote on Nov 8th
and we are submitting their Stage II in February 2023

Schedule Duration - Upon definition of the “Project”

- Design & Documentation min. 30 days
- Estimating min. 30 days
- Cost Reconciliation min. 15 days
- Preparation for below min. 15 days

90 consecutive, productive, intense days

Schedule Duration - Upon definition of the “Project”

BEFORE SUBMISSION...

- School Building Committee Recommendations
 - School Committee Approval
 - Town Council Approval
- “Project”
Scope & Cost



Schedule Duration - Upon definition of the “Project”

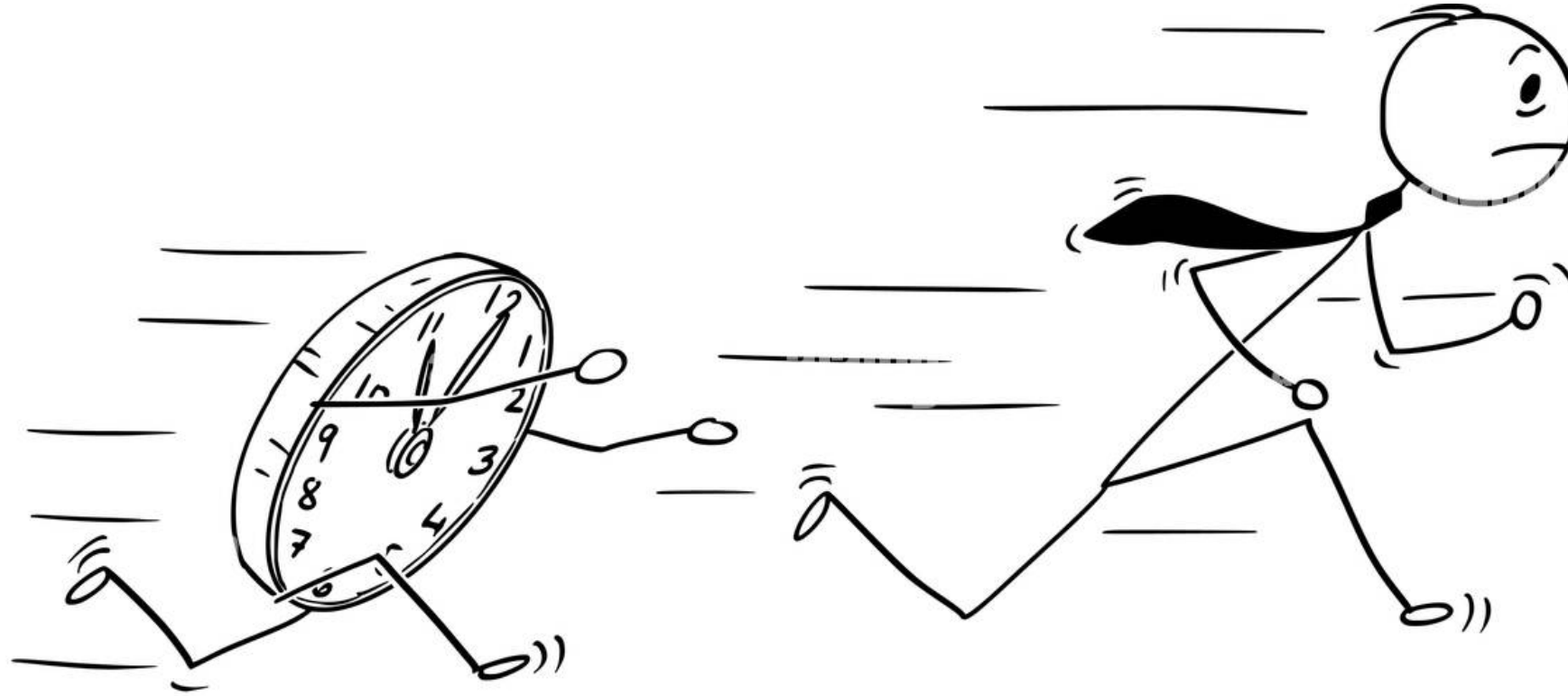

It will feel “RUSHED”

Schedule Duration - Upon definition of the “Project”

You have Options...

Submit after February 15th 2023 (May or June 2023)

Council on Elementary & Secondary Education in October 2023

Maintain eligibility for bonus and incentives

Able to prepare in advance

Bond Vote?

A/E, CM, OPM Selection?

Schedule Duration - Upon definition of the “Project”

Value...

Enables greater due diligence

Allows for more input and greater confidence in the “Project”

Appropriately introduces project to new SC & TC members

Allows for redirection if necessary \$\$\$

Workshop Approach

This Workshop is **NOT** intended
to select a site!

Workshop Approach

- Deliver a short presentation of work to date
Explain how participants can respond
- Present sites for a New Build under consideration
Responsibly
Without prejudice

Workshop Approach

- Ask the participants to get informed & note “their” perceived:

Advantages

Disadvantages

Concerns

Positive Aspects

Negative Aspects

- Use the Selection Criteria List, to date, as “**prompts**” and/or add to the list

Workshop Approach – Selection Criteria Prompts

- Town Owned Property
- Ability to construct an Athletic Complex adjacent to the High School
- Swing Space Required
- Safely walkable from dense residential areas
- Availability for Parking
- Increased traffic impact within neighboring community
- Requires District Office to be relocated
- Allows for future building expansion
- Full Size Auditorium that is reimbursed fully by RIDE
- Meets educational space needs
- Sustainable features & Green opportunities
- ???

Boards
for 11/5
Workshop



Curtis Corner

Boards
for 11/5
Workshop

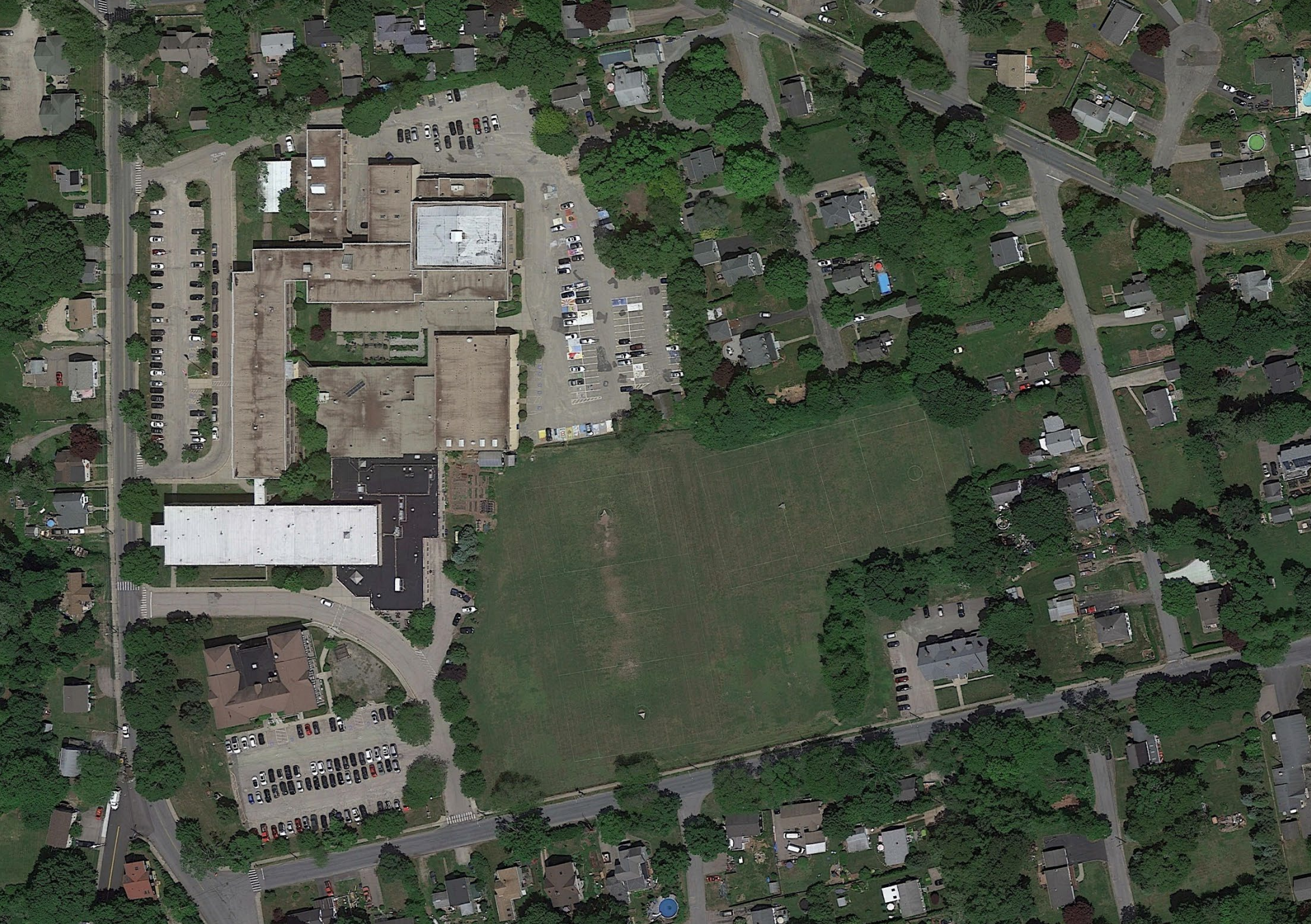

Columbia Street

Boards
for 11/5
Workshop



Recreational Center

Boards for 11/5 Workshop

New High School

Building

700 Students -158,000 sq.ft.

Fully Integrated Academic,
Career & Technical School

Features

- New Classrooms & Labs
- New CTE Spaces
- New Cafeteria
- New Administrative Offices
- New Gymnasium Facilities,
- Renovated** Auditorium
- Existing Practice Fields
- New Remote Stadium
- New Parking & Roadways

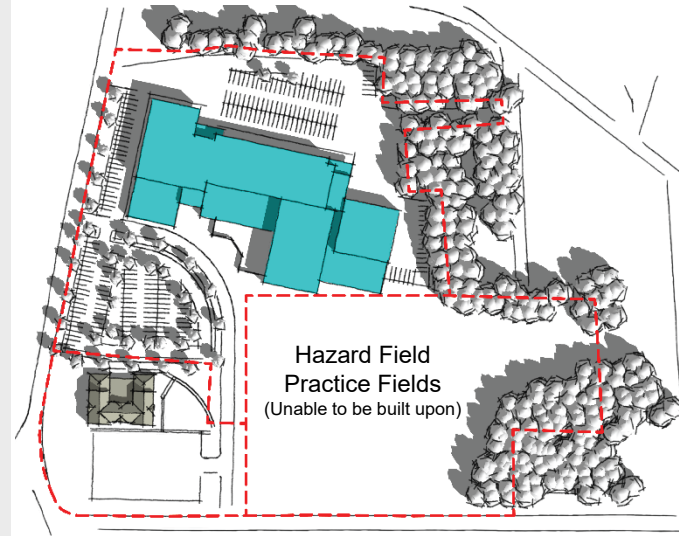

Layout 01

New High School

Building

700 Students -158,000 sq.ft.

Fully Integrated Academic,
Career & Technical School

Features

- New Classrooms & Labs
- New CTE Spaces
- New Cafeteria
- New Administrative Offices
- New Gymnasium Facilities,
- New** Auditorium
- Existing Practice Fields
- New Remote Stadium
- New Parking & Roadways

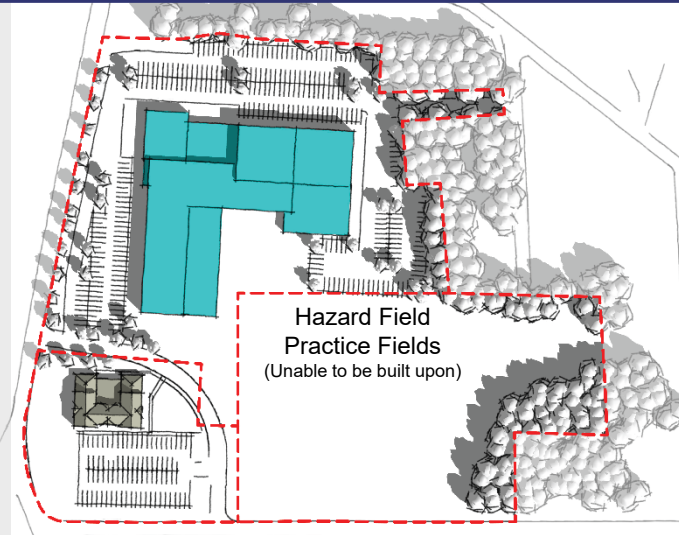

Layout 02

Boards
for 11/5
Workshop

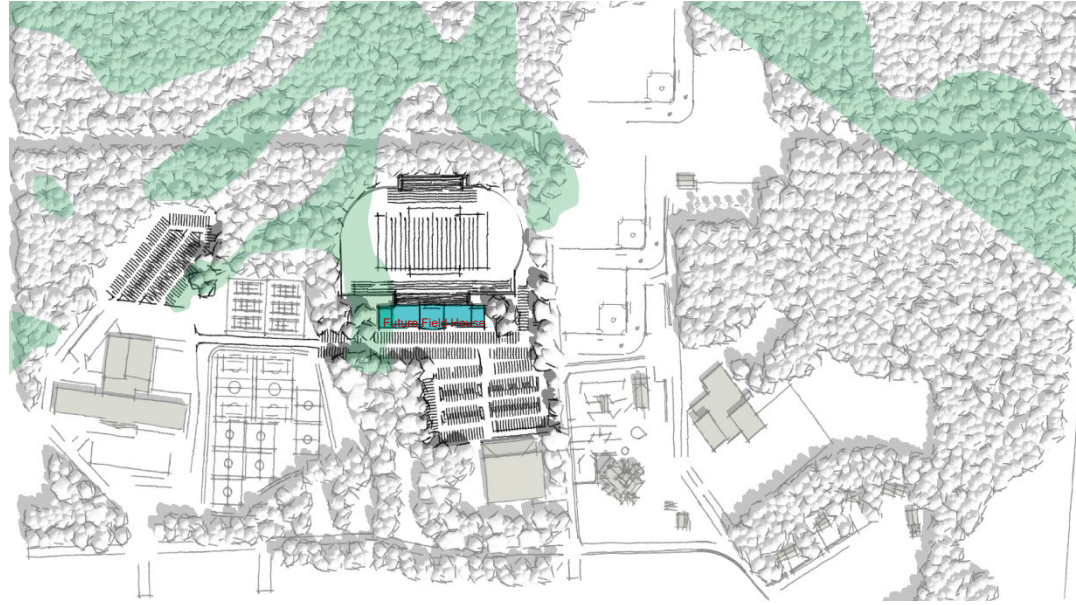

Layout 01

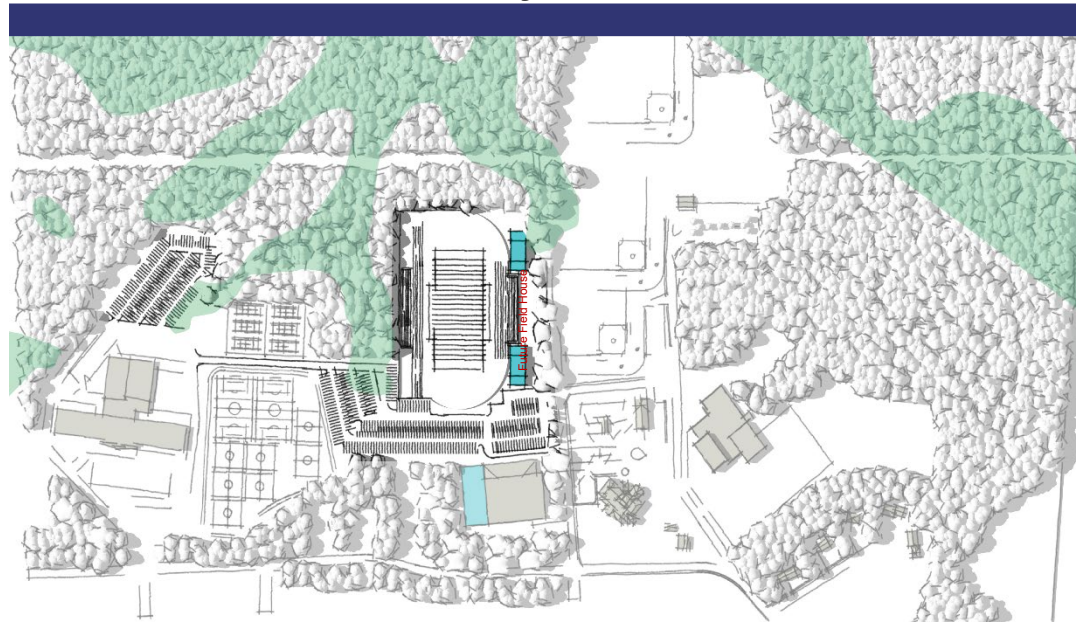

Layout 02

Stadium at Recreational Center

Boards
for 11/5
Workshop

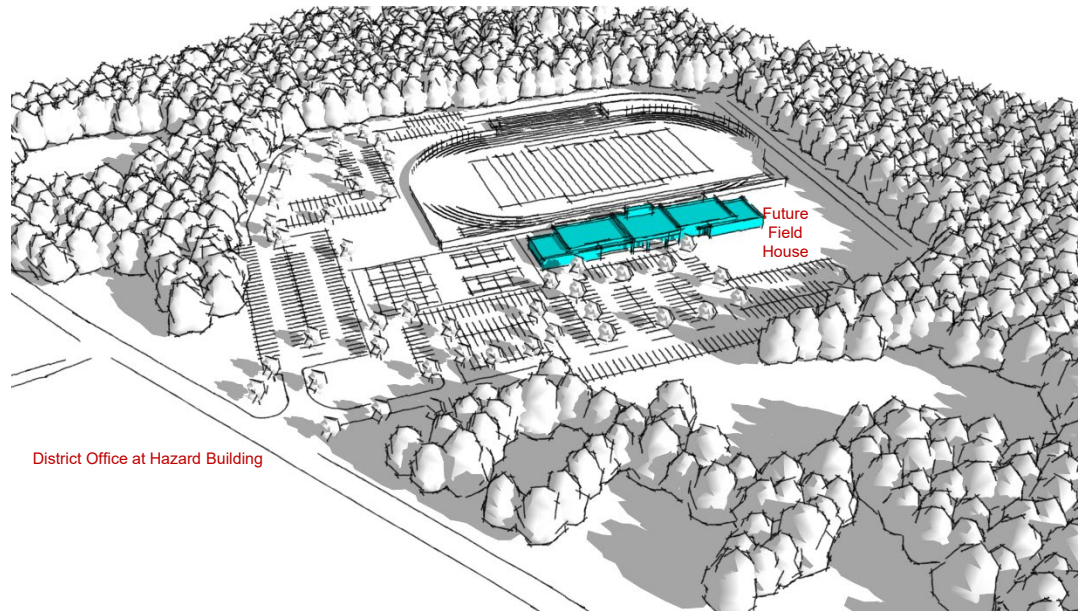
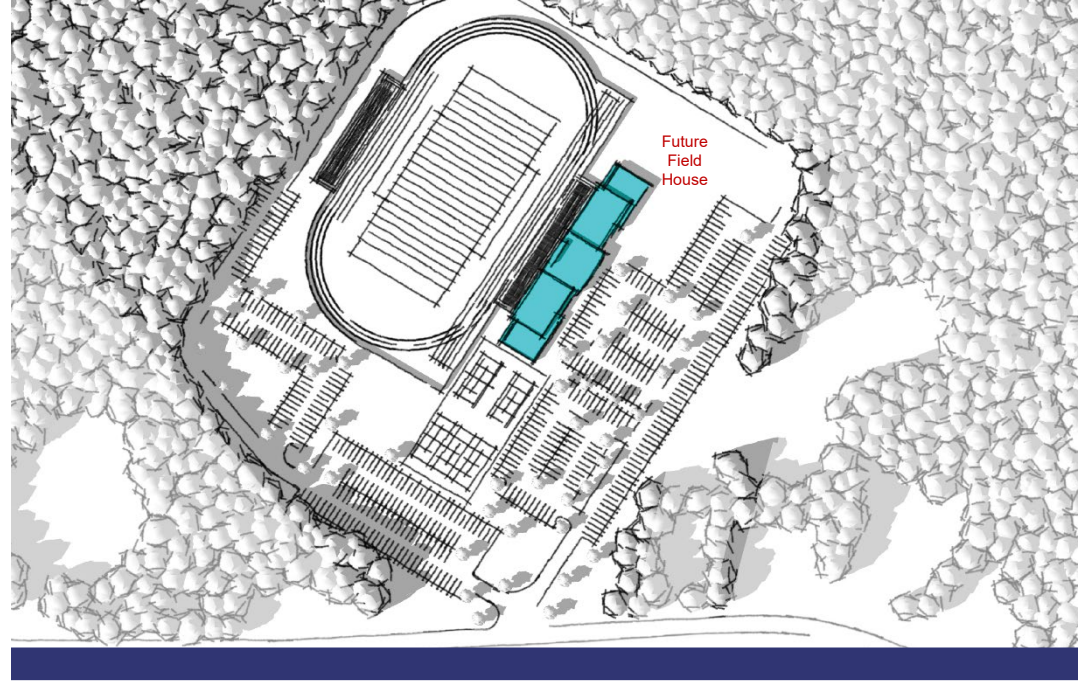

District Office at Hazard Building

Stadium at Curtis Corner

Boards for 11/5 Workshop

New High School

Building

700 Students -158,000 sq.ft.

Fully Integrated Academic,
Career & Technical School

Features

New Classrooms & Labs

New CTE Spaces

New Cafeteria

New Administrative Offices

New Gymnasium Facilities,

New Auditorium

New Fields & Stadium

New Parking & Roadways

District Office at Hazard
Building

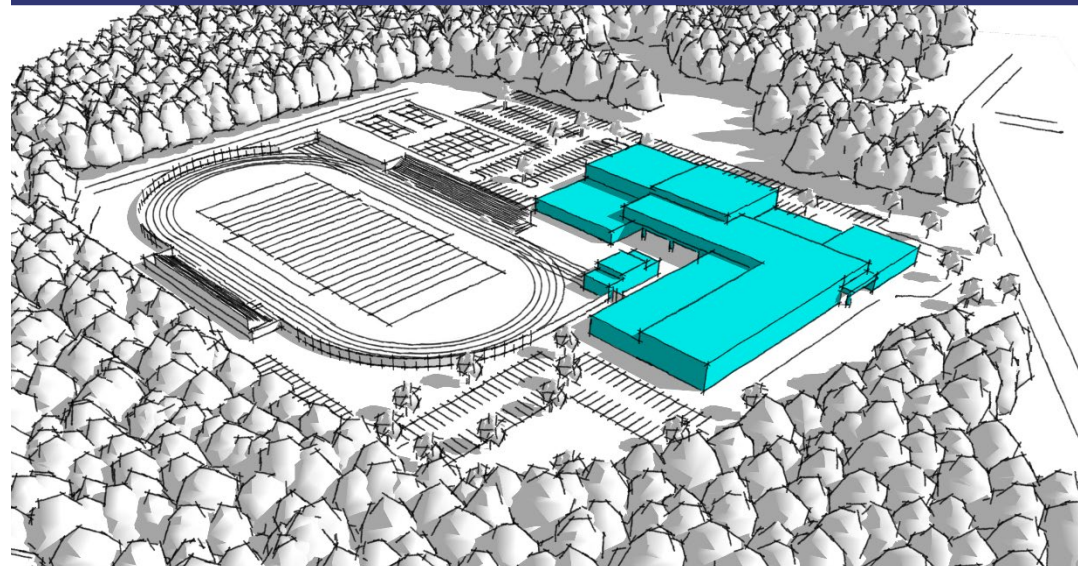
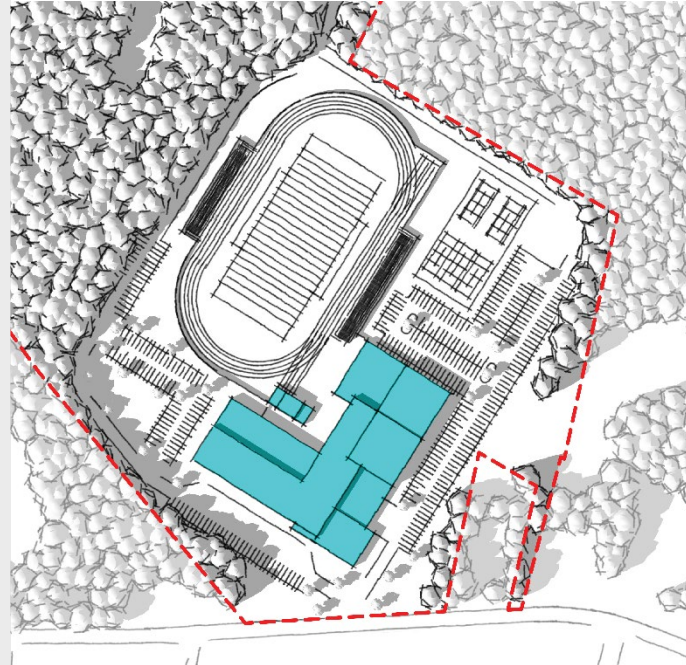

Curtis Corner Site

Next Steps

- Consider delaying submission in February 2023
- Develop a Schedule & Tasks working towards May/June 2023
 - Additional Community Workshops?
 - Additional investigation as necessary
- Continue to solicit feedback from the community
- Continue to share with SC & TC re: “Project”

END

Athletic Stadium Options

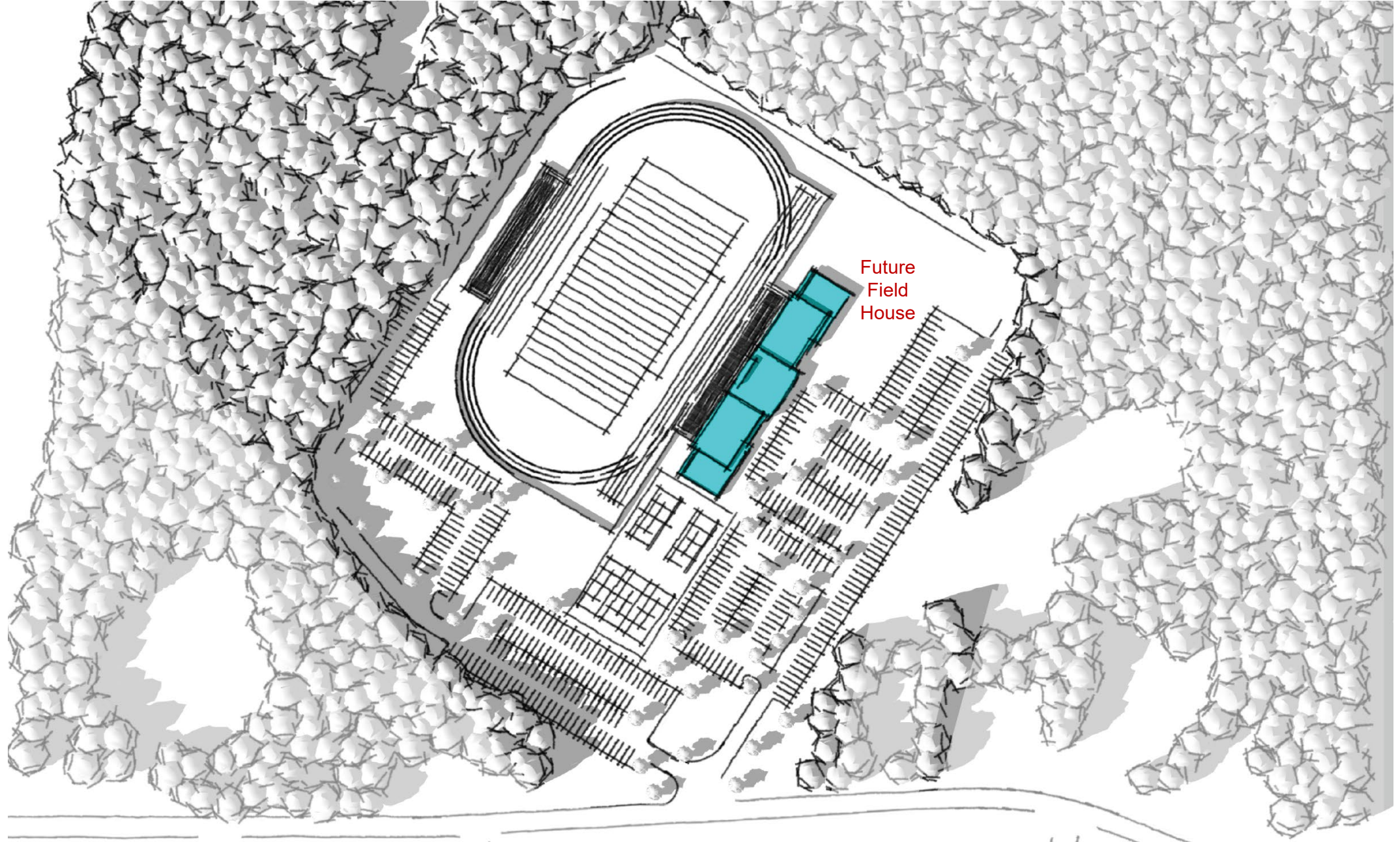

Athletic Stadium Options

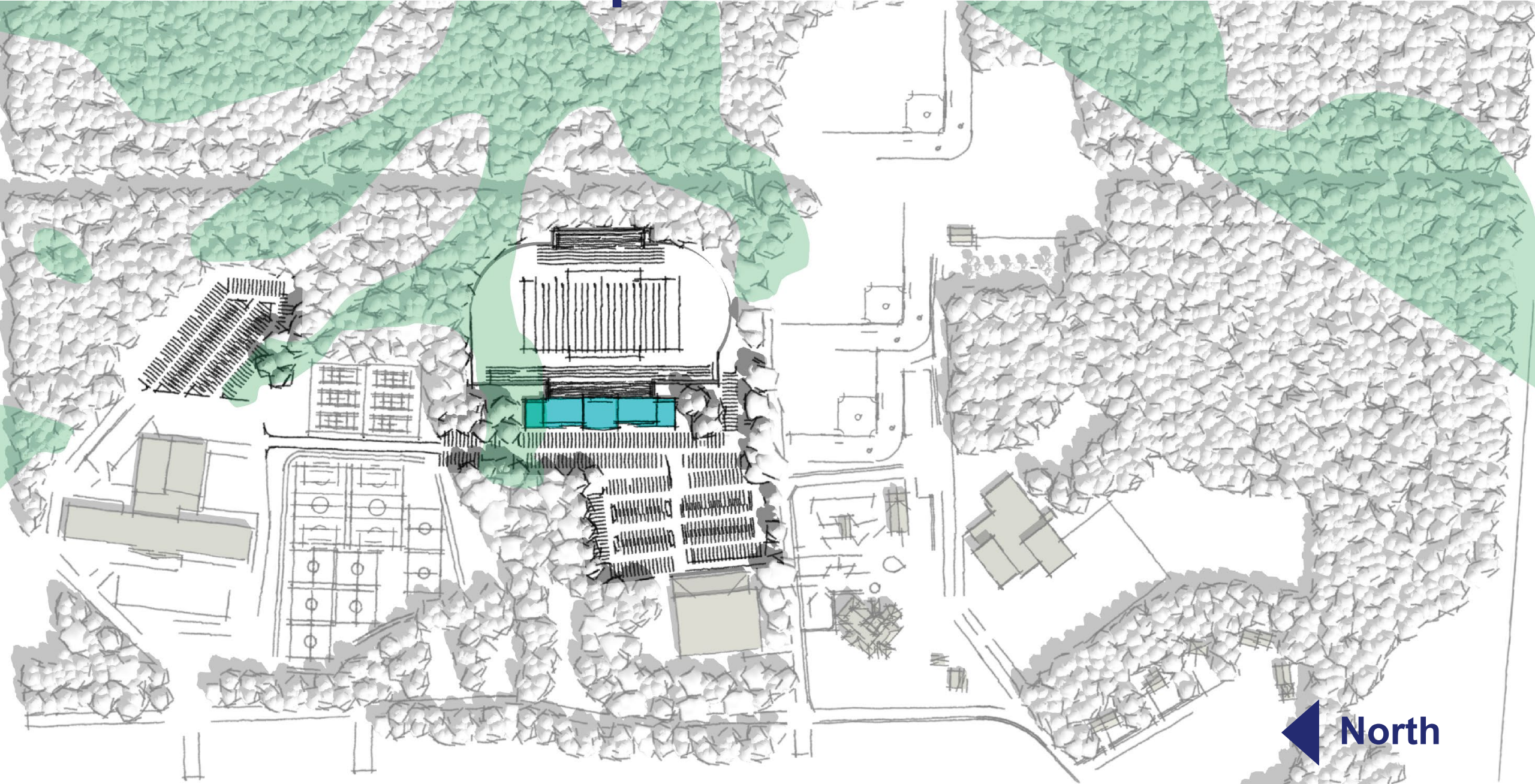

Athletic Stadium Options

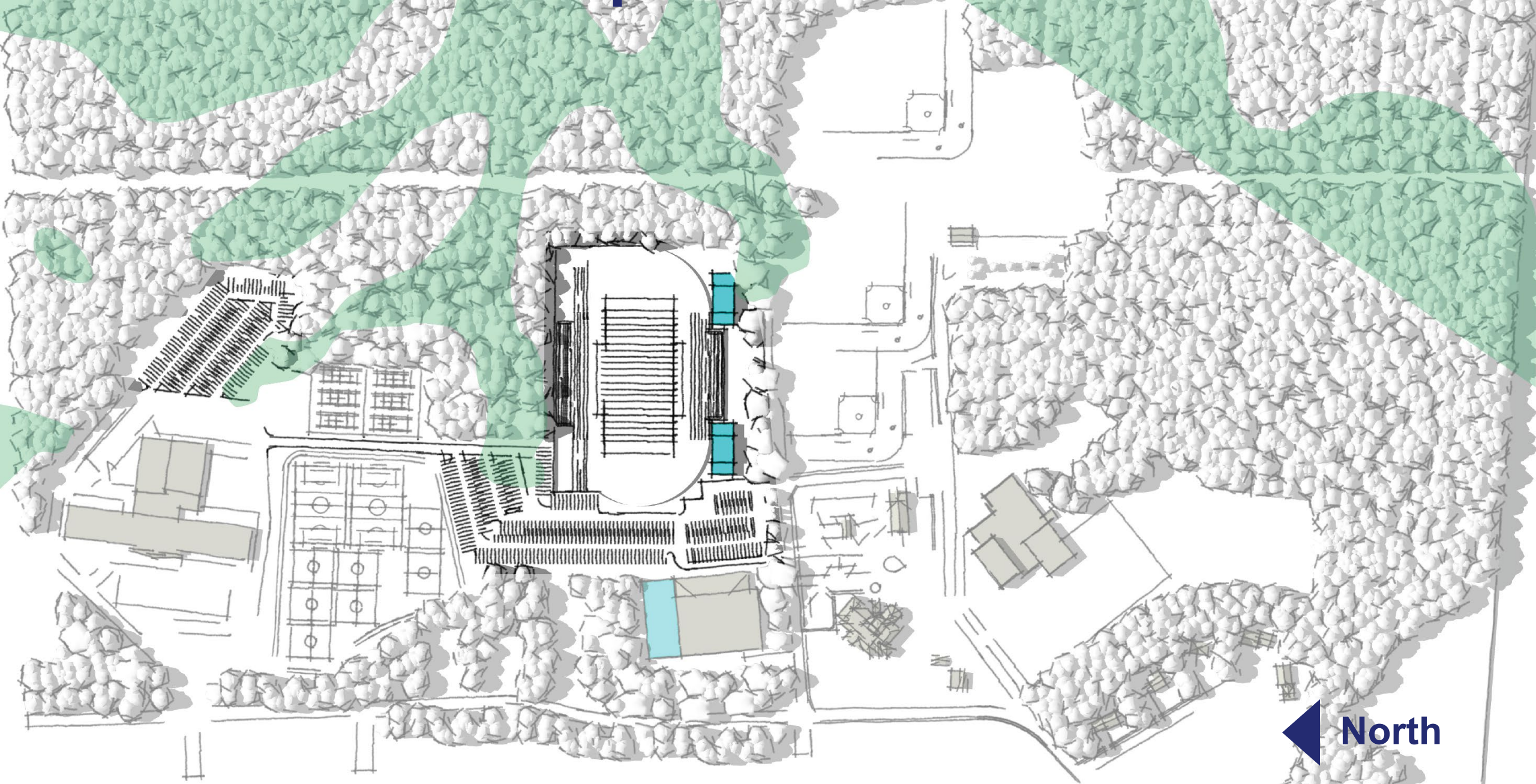



END